



40'X76' BUILDING

SIGN#1

EL FORASTERO
MEXICAN FOOD

Sign facing Broadway Street

156"

EL FORASTERO
MEXICAN FOOD

30"

12"

TOTAL: 61'.75 SQFT

DESCRIPTION:
New channel letter
sign to display
business name
to call attention
for potential customers

57"

SIGN LOCATION:
1365 Broadway, Placerville 95667

PACOS GRAFFIX & SIGNS
524 E. LODI AVE,
LODI CA 95240
CA LIC#1045803
209-327-9551

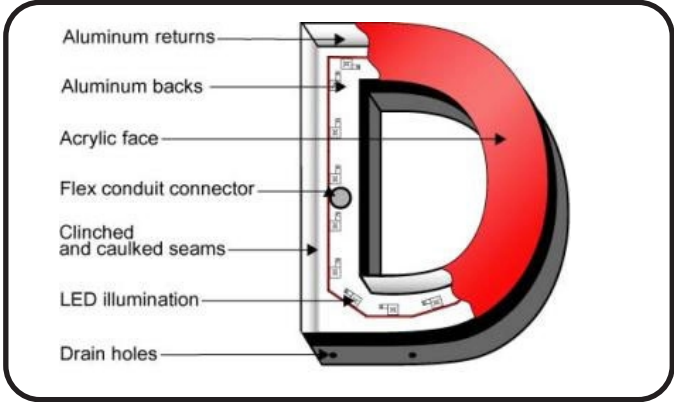

SIGN SPECIFICATIONS

- ALUMINUM CHANNEL LETTERS
.040 mm BLACK ALUMINUM COIL
156"x57"x5"
- 1 SIDED LIGHTED
- LIGHTING TYPE: LED LIGHTS
Ampacity of circuit breaker: 20 amp
Light Details: Outdoor LED 12v/5 amp
Input 120v/1.4 amp / 60 w transformer
- 2016 CA ENERGY STANDARDS
- 2016 CBC & CEC
- FACE: 1/8 WHITE ACRYLIC
- BORDER: BLACK TRIM CAP
- 1-ATTACHMENT TO BUILDING
1/8"x2.5" SCREWS = 4 PER LETTER

Letter Cross Section Detail

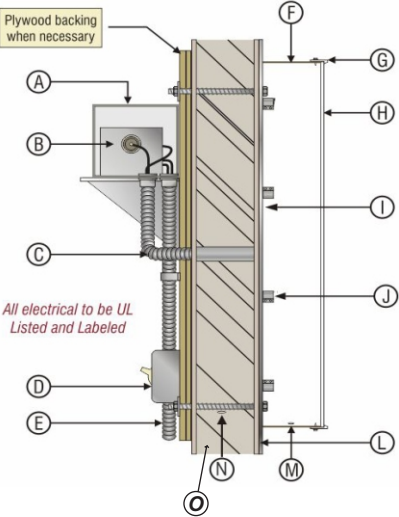

A	transformer housing
B	transformer:
C	conduit (1/2" min.)
D	listed disconnect switch
E	primary electrical source
F	5" (.063) aluminum return
G	1" trim cap
H	3/16" thick plex face
I	electrical boot
J	LED
K	
L	Aluminum panel w/vinyl graphics & uv guard
M	weep holes
N	1/8"x2.5" SCREWS = 4 PER LETTER
O	Stacco



SIGN FACING PARKING LOT



SIGN #3



EXISTING SIGN



NEW SIGN

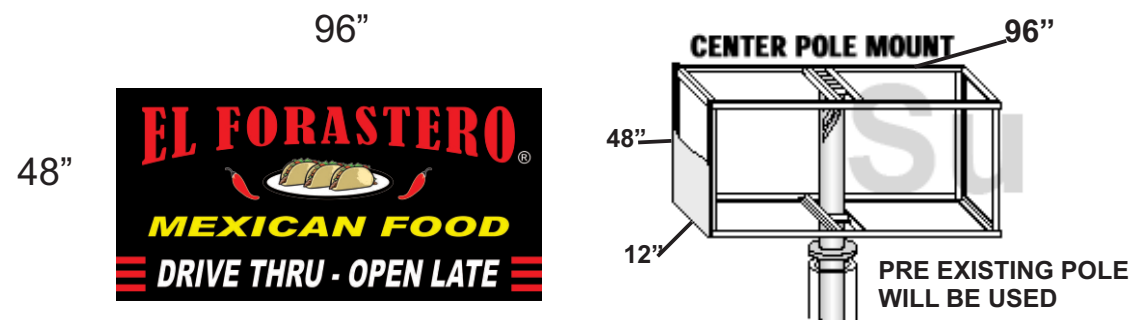

DOUBLE SIDED SIGN
TOTAL: 32' SQFT

SIGN SPECIFICATIONS

- ALUMINUM SIGN CABINET
- .040 mm BLACK ALUMINUM COIL
- 96"X48"X12"
- SIGN #2 - 1 SIDED LIGHTED
- SIGN #3 - DOUBLE SIDED LIGHTED
- LIGHTING TYPE: LED LIGHTS
- Ampacity of circuit breaker: 20 amp
- Light Details: Outdoor LED 12v/5 amp
- Input 120v/1.4 amp / 60 w transformer
- 2016 CA ENERGY STANDARDS
- 2016 CBC & CEC
- FACE: 1/8 WHITE ACRYLIC
- BLACK BLOCKED BACKGROUND, AT NIGHT
TIME ONLY TEXT WILL BE ILLUMINATED
- 1- ATTACHMENT TO BUILDING
- 1/2"X4" SCREWS BOLTS = 6 PER BOX

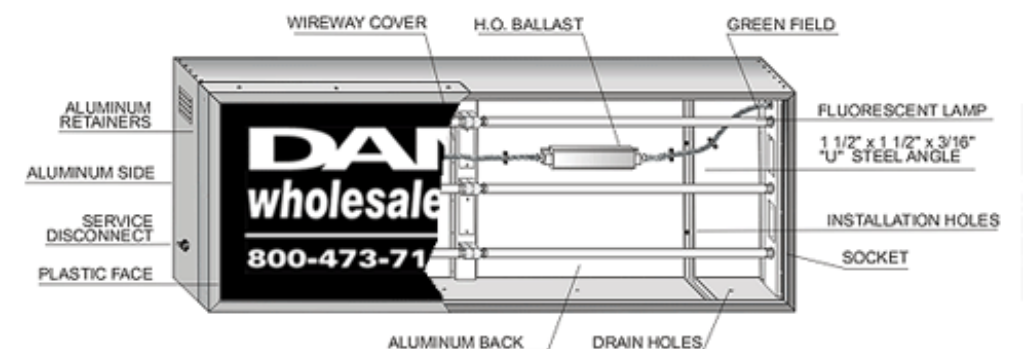

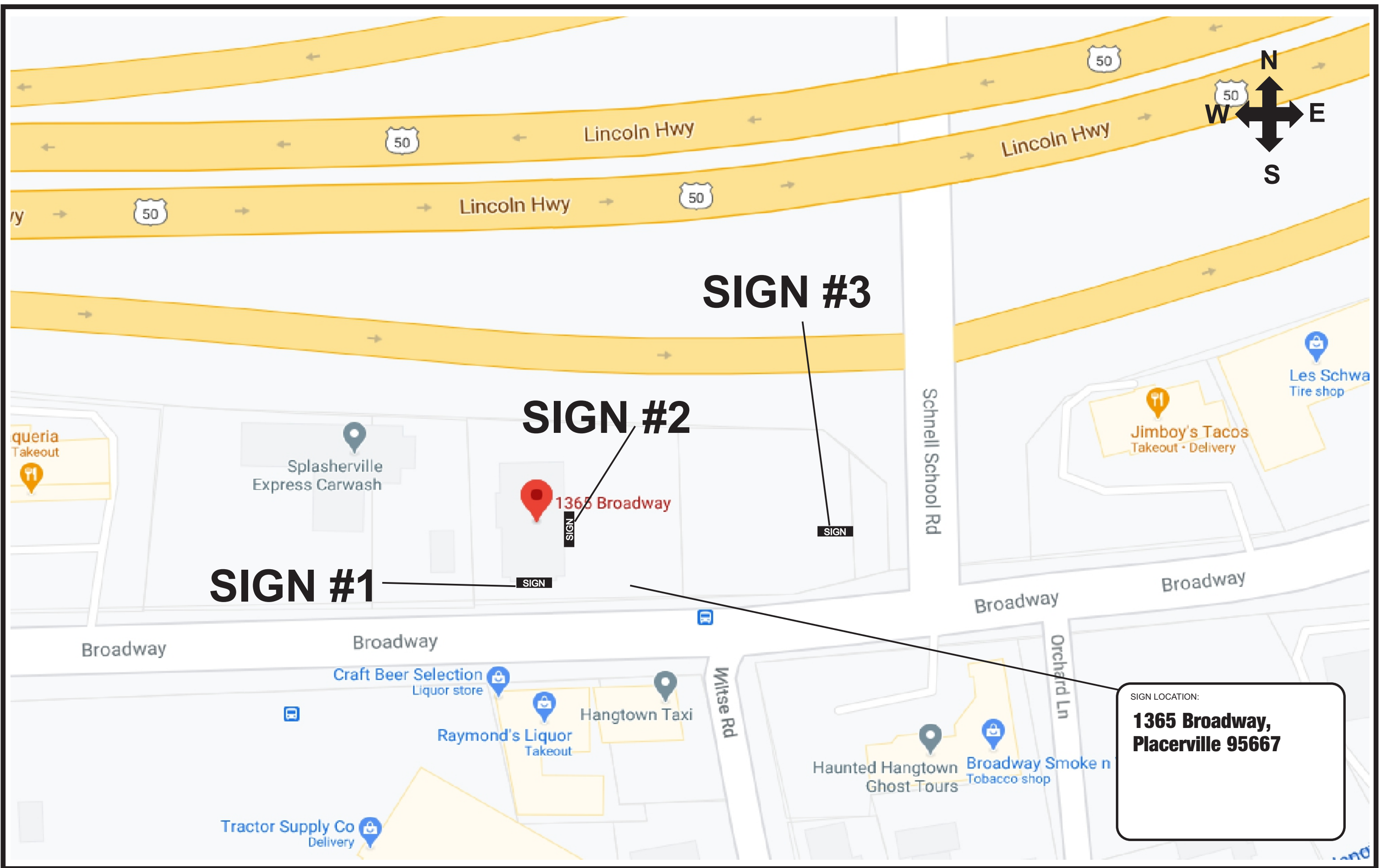

SIGN #1

SIGN #2

SIGN #3

SIGN LOCATION:

**1365 Broadway,
Placerville 95667**